



## Manual winch BHW



## Features

- » Suitable for lifting and pulling applications.
- » Breaking action through worm wheel gearing.
- » Efficient gearing minimises the required operator effort.
- » Compact design with detachable lever.
- » Comfortable handle with easy grip.
- » Supplied without steel cable.
- » Complies with the Machinery Directive 2006/42/EC. Supplied with test certificate, CE declaration of conformity and operating instructions.

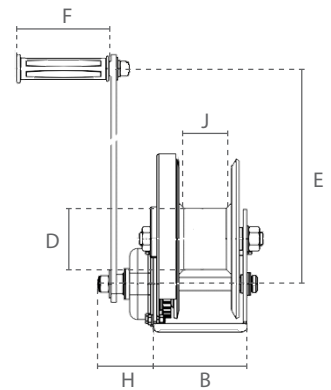
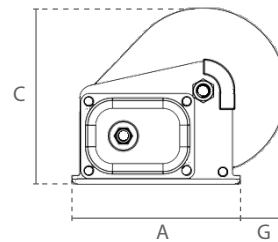

Specifications					
Article code	Capacity		Pulling capacity		Material
	1st layer ton	topmost layer ton	1st layer ton	topmost layer ton	
DS.0.BHW.1200	0,280	0,120	0,550	0,240	galvanised steel
DS.0.BHW.1800	0,410	0,180	0,820	0,360	
DS.0.BHW.2600	0,590	0,320	1,180	0,640	
DS.0.BHW.1200RV	0,220	0,100	0,440	0,190	304(V2A) stainless steel
DS.0.BHW.1800RV	0,330	0,150	0,660	0,290	
DS.0.BHW.2600RV	0,470	0,260	0,940	0,520	

Specifications				
Article code	Effort for max load	Gear ratio	Recommended steel cable	Net weight
	N		19x7 1960 N/mm <sup>2</sup> m x Ømm	kg
DS.0.BHW.1200	180	4,2:1	20 x 5	3,7
DS.0.BHW.1800	190	5:1	20 x 7	8,1
DS.0.BHW.2600	190	9:1	13 x 8	10,3

Specifications	
Minimum load	3 % WLL
Overload protection	No overload protection
Load type	Goods, may not be used to lift or transport people

Dimensions (mm)									
Article code	A	B	C	D	E	F	G	H	J
DS.0.BHW.1200	138	88	156	48	208	110	46	57	51
DS.0.BHW.1800	193	107	203	60	319	110	53	60	60
DS.0.BHW.2600	240	127	216	75	319	110	54	63	63