



Rigging equipment Grade 100

Clevis hooks with latch
Eye hooks with latch
Swivel hooks with latch and bearing



YE.10.043

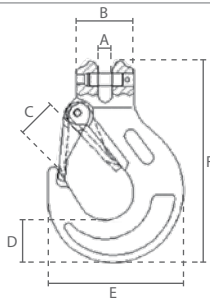

YE.10.044

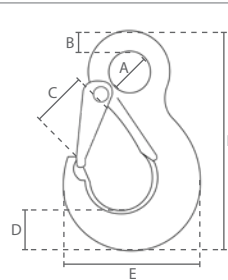

YE.10.088

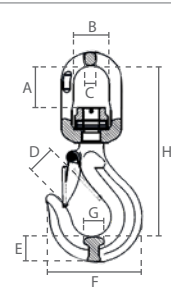

Specifications			Dimensions (mm)					
Article code	Capacity (ton)	Weight (kg)	A	B	C	D	E	F
YE.10.043.06	1,400	0,4	8	32	19	21	69	109
YE.10.043.08	2,500	0,7	10	37	25	28	88	134
YE.10.043.10	4,000	1,3	12	48	28	34	106	162
YE.10.043.13	6,700	2,3	15	59	38	42	134	203
YE.10.043.16	10,000	3,6	18	70	44	50	161	248
YE.10.043.20	16,000	7,3	25	85	52	56	191	297
YE.10.043.22	19,000	12,1	27	100	66	62	215	326

Specifications			Dimensions (mm)					
Article code	Capacity (ton)	Weight (kg)	A	B	C	D	E	F
YE.10.044.06	1,400	0,3	21	10	19	21	70	111
YE.10.044.08	2,500	0,6	25	11	25	28	86	138
YE.10.044.10	4,000	1,2	34	16	28	33	105	172
YE.10.044.13	6,700	2,2	43	19	38	44	132	219
YE.10.044.16	10,000	3,5	50	25	44	50	160	260
YE.10.044.20	16,000	7,2	55	27	52	56	190	298
YE.10.044.22	19,000	11,5	60	29	66	62	214	330
YE.10.044.26	26,500	12,2	70	35	73	75	245	376
YE.10.044.32	39,300	17,5	82	39	87	89	270	458

Specifications			Dimensions (mm)							
Article code	Capacity (ton)	Weight (kg)	A	B	C	D	E	F	G	H
YE.10.088.06	1,400	0,7	37	33	12	24	19	71	16	141
YE.10.088.08	2,500	1,0	42	41	13	29	26	88	20	171
YE.10.088.10	4,000	1,7	51	48	16	34	30	105	25	216
YE.10.088.13	6,700	3,1	59	55	17	40	38	135	32	253
YE.10.088.16	10,000	5,5	68	61	22	45	45	161	38	293
YE.10.088.20	16,000	9,8	91	74	25	56	50	195	49	359