

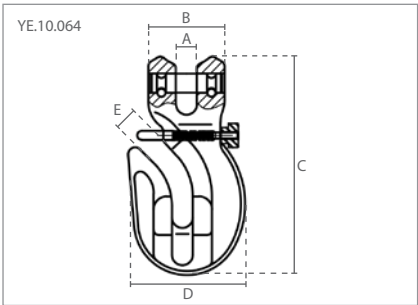

Rigging equipment Grade 100

Clevis grab hooks
Clevis grab hooks with safety pin

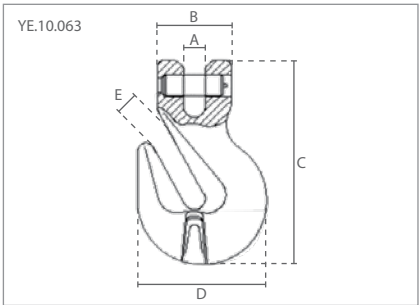

| Specifications | | | Dimensions (mm) | | | | |
|----------------|----------------|-------------|-----------------|-----|-----|-----|----|
| Article code | Capacity (ton) | Weight (kg) | A | B | C | D | E |
| YE.10.063.06 | 1,400 | 0,2 | 8 | 32 | 78 | 47 | 8 |
| YE.10.063.08 | 2,500 | 0,4 | 10 | 36 | 93 | 54 | 11 |
| YE.10.063.10 | 4,000 | 0,8 | 13 | 46 | 127 | 72 | 14 |
| YE.10.063.13 | 6,700 | 1,8 | 15 | 59 | 164 | 96 | 15 |
| YE.10.063.16 | 10,000 | 2,9 | 19 | 70 | 188 | 115 | 19 |
| YE.10.063.20 | 16,000 | 4,9 | 24 | 85 | 223 | 145 | 25 |
| YE.10.063.22 | 19,000 | 8,3 | 27 | 100 | 260 | 159 | 27 |

| Specifications | | | Dimensions (mm) | | | | |
|----------------|----------------|-------------|-----------------|----|-----|-----|----|
| Article code | Capacity (ton) | Weight (kg) | A | B | C | D | E |
| YE.10.064.06 | 1,400 | | | | | | |
| YE.10.064.08 | 2,500 | 0,6 | 10 | 38 | 109 | 58 | 11 |
| YE.10.064.10 | 4,000 | 1 | 12 | 46 | 134 | 72 | 13 |
| YE.10.064.13 | 6,700 | 2,6 | 15 | 60 | 176 | 96 | 16 |
| YE.10.064.16 | 10,000 | 4,2 | 19 | 70 | 208 | 107 | 19 |