

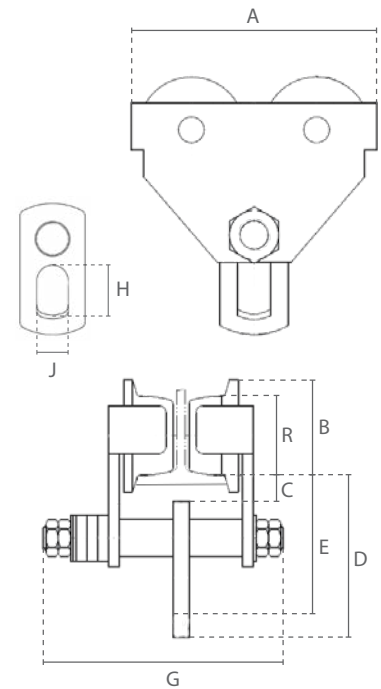

## Sparkproof push trolley

**Features**

- » Suitable for potentially dangerous and explosive environments. ATEX Zone 1 CE EX II 2G h IIC T4 / 2D h IIC T135°C
- » Completely copper-plated, with bronze-plated wheels.
- » Customisable by adjusting the spacers.
- » Safety bars serve as fall-, breaking- and impact protection. Additionally equipped with tilting protection.
- » Permanently lubricated, ball bearing mounted wheels allow for smooth traversing.
- » Suitable for most I- and H-beam profiles.
- » Complies with the Machinery Directive 2006/42/EC. Supplied with test certificate, CE declaration of conformity and operating instructions.

## Specifications

Article code	Capacity	Suitable beam width	Min. radius	Wheel diameter (R)	Net weight
	ton	mm	m	mm	kg
DC.0.03200500	0,500	64-140	0,6	58	7
DC.0.03201000	1,000	64-140	0,8	75	12
DC.0.03202000	2,000	76-165	1,1	90	20,5
DC.0.03203000	3,000	76-305	1,4	110	36,8
DC.0.03205000	5,000	88-305	1	122	56
DC.0.03210000	10,000	125-305	1,3	151	91,9
DC.0.03220000	20,000	136-305	4,7	200	230,8

## Dimensions (mm)

Capacity	A	B	C	D	E	G	H	J
0,500	212	70	28	128	113	230	38	24
1,000	255	88	25	143	128	254	50	30
2,000	302	105	27	172	152	294	60	36
3,000	344	126	32	212	186	446	75	45
5,000	378	141	34	254	224	468	95	60
10,000	455	170	37	322	275	505	120	82
20,000	642	238	54	384	314	549	150	110