



## Premium Magnetic lifter



## Features

- » Suitable for lifting and handling steel plates, -blocks or -pipes.
- » With permanent NdFeB magnet.
- » Magnetic field is produced by turning the handle.

**Premium features:**

- » Steel block protects the lever from shocks.
- » More stability due to fixed suspension eye.
- » Safe handling by unlocking on the housing (instead of at the lever).
- » Complies with the Machinery Directive 2006/42/EC. Supplied with test certificate, CE declaration of conformity and operating instructions.

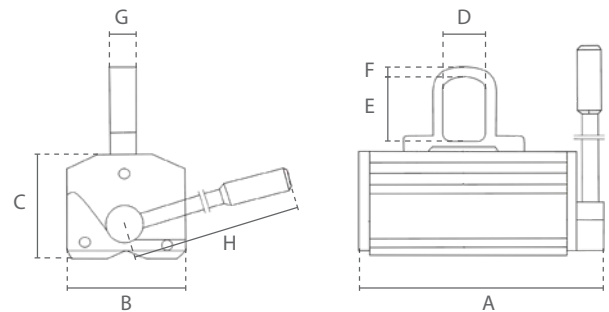

Specifications				
Article code	Capacity		Min. plate thickness	Safety factor
	Flat material	Round material		
	ton	ton		
DC.0.QML.0100	0,100	0,050	20	3,5
DC.0.QML.0300	0,300	0,150	25	
DC.0.QML.0600	0,600	0,300	30	
DC.0.QML.1000	1,000	0,500	40	
DC.0.QML.2000	2,000	1,000	60	
				Net weight
				kg
				4
				11
				21
				42
				105

Dimensions (mm)								
Capacity	A	B	C	D	E	F	G	H
0,100	137	62	66	21	32	8	15	120
0,300	199	90	95	38	50	11	22	175
0,600	263	115	107	42	58	13	25	225
1,000	303	150	147	50	64	18	29	266
2,000	417	190	195	56	76	21	37	415



QML vs DML

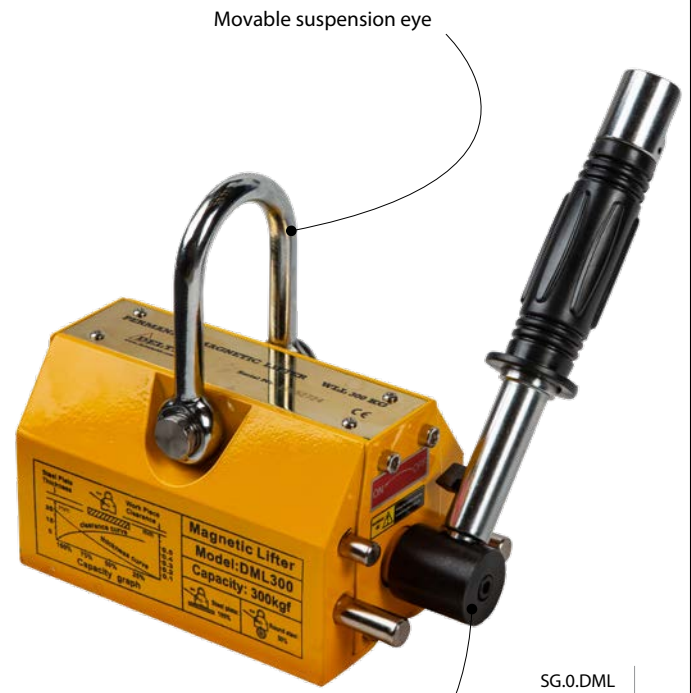

Safe handling by unlocking on the housing



Unlocking on the lever