

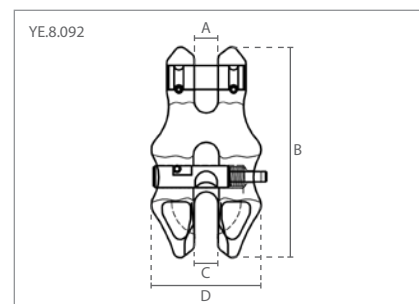

Rigging equipment according to EN 1677 Grade 80

Clevis grab hooks  
 Clevis grab hooks with safety pin  
 Clevis chain clutches with safety pin

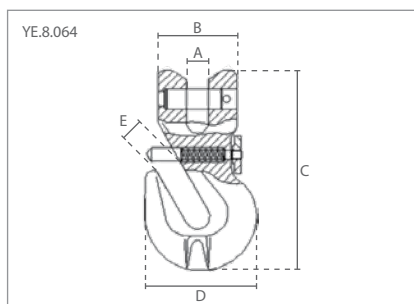
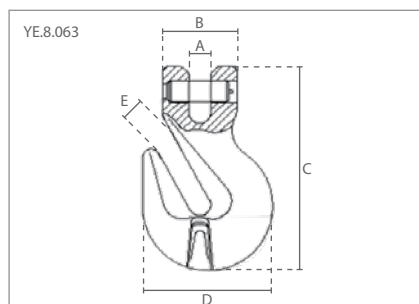

| Specifications |                |             | Dimensions (mm) |     |     |     |    |
|----------------|----------------|-------------|-----------------|-----|-----|-----|----|
| Article code   | Capacity (ton) | Weight (kg) | A               | B   | C   | D   | E  |
| YE.8.063.06    | 1,120          | 0,3         | 8               | 32  | 77  | 45  | 8  |
| YE.8.063.08    | 2,000          | 0,3         | 10              | 39  | 89  | 53  | 11 |
| YE.8.063.10    | 3,150          | 0,7         | 13              | 47  | 126 | 71  | 13 |
| YE.8.063.13    | 5,300          | 1,6         | 15              | 53  | 164 | 96  | 17 |
| YE.8.063.16    | 8,000          | 2,8         | 19              | 70  | 184 | 113 | 19 |
| YE.8.063.20    | 12,500         | 5,1         | 23              | 81  | 219 | 143 | 24 |
| YE.8.063.22    | 15,000         | 6,3         | 27              | 91  | 254 | 160 | 27 |
| YE.8.063.26    | 21,200         | 14,5        | 30              | 117 | 309 | 181 | 30 |
| YE.8.063.32    | 31,500         | 24,3        | 35              | 150 | 378 | 229 | 41 |

| Specifications |                |             | Dimensions (mm) |    |     |     |    |
|----------------|----------------|-------------|-----------------|----|-----|-----|----|
| Article code   | Capacity (ton) | Weight (kg) | A               | B  | C   | D   | E  |
| YE.8.064.06    | 1,120          | 0,3         | 8               | 32 | 75  | 44  | 8  |
| YE.8.064.08    | 2,000          | 0,4         | 10              | 35 | 89  | 50  | 11 |
| YE.8.064.10    | 3,150          | 0,9         | 13              | 43 | 127 | 71  | 14 |
| YE.8.064.13    | 5,300          | 1,9         | 15              | 63 | 164 | 90  | 17 |
| YE.8.064.16    | 8,000          | 3,3         | 20              | 66 | 184 | 113 | 20 |

| Specifications |                |             | Dimensions (mm) |     |    |    |
|----------------|----------------|-------------|-----------------|-----|----|----|
| Article code   | Capacity (ton) | Weight (kg) | A               | B   | C  | D  |
| YE.8.092.06    | 1,120          | 0,2         | 8               | 73  | 8  | 38 |
| YE.8.092.08    | 2,000          | 0,5         | 10              | 92  | 10 | 50 |
| YE.8.092.10    | 3,150          | 0,8         | 13              | 115 | 13 | 60 |
| YE.8.092.13    | 5,300          | 1,7         | 15              | 149 | 15 | 79 |
| YE.8.092.16    | 8,000          | 3,9         | 19              | 184 | 19 | 98 |