

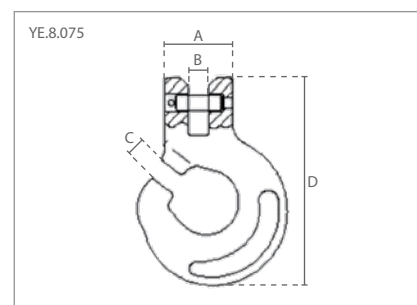

Accesorios según EN 1677 Grado 80

Ganchos de fundición de horquilla
Ganchos de fundición de ojo
Ganchos choker

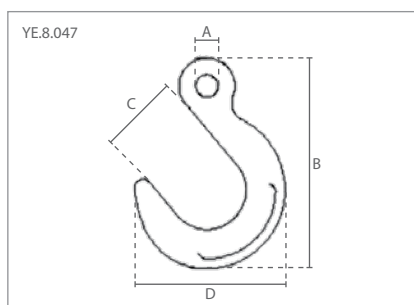
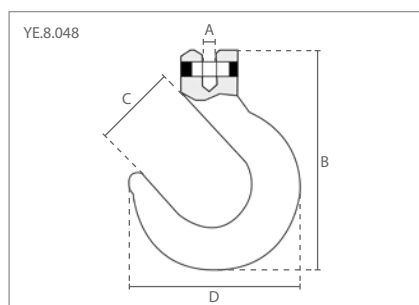

| Especificaciones | | | Dimensiones (mm) | | | |
|--------------------|-----------------|-----------|------------------|-----|----|-----|
| Código de artículo | Capacidad (ton) | Peso (kg) | A | B | C | D |
| YE.8.048.08 | 2,000 | 1,1 | 10 | 161 | 64 | 128 |
| YE.8.048.10 | 3,150 | 2,5 | 13 | 199 | 77 | 156 |

| Especificaciones | | | Dimensiones (mm) | | | |
|--------------------|-----------------|-----------|------------------|-----|-----|-----|
| Código de artículo | Capacidad (ton) | Peso (kg) | A | B | C | D |
| YE.8.047.06 | 1,120 | 1,0 | 18 | 163 | 64 | 120 |
| YE.8.047.08 | 2,000 | 1,1 | 18 | 163 | 64 | 120 |
| YE.8.047.10 | 3,150 | 2,1 | 22 | 200 | 76 | 146 |
| YE.8.047.13 | 5,300 | 3,2 | 27 | 238 | 89 | 171 |
| YE.8.047.16 | 8,000 | 5,6 | 32 | 278 | 102 | 198 |
| YE.8.047.20 | 12,500 | 8,8 | 38 | 325 | 115 | 232 |
| YE.8.047.22 | 15,000 | 12,0 | 45 | 361 | 128 | 256 |
| YE.8.047.26 | 21,200 | 17,0 | 68 | 402 | 140 | 283 |
| YE.8.047.32 | 31,500 | 26,6 | 82 | 461 | 154 | 327 |

| Especificaciones | | | Dimensiones (mm) | | | |
|--------------------|-----------------|-----------|------------------|----|----|-----|
| Código de artículo | Capacidad (ton) | Peso (kg) | A | B | C | D |
| YE.8.075.08 | 2,000 | 0,5 | 35 | 10 | 11 | 96 |
| YE.8.075.10 | 3,150 | 1,0 | 44 | 13 | 13 | 137 |
| YE.8.075.13 | 5,300 | 1,8 | 53 | 15 | 16 | 165 |